



## CAUTION

**TURN OFF THE MAIN POWER AT THE CIRCUIT BREAKER BEFORE INSTALLING THE FIXTURE IN ORDER TO PREVENT POSSIBLE SHOCK**

**IF YOU ARE UNFAMILIAR WITH PROPER ELECTRICAL WIRING CONNECTIONS, OBTAIN THE SERVICES OF A QUALIFIED ELECTRICIAN**

## GENERAL

- Read all instructions carefully for safe operation and installation.
- All electrical connections must be in accordance with local and national electrical code (N.E.C) standards.
- Remove the fixture and the mounting package from the box and make sure that no parts are missing by referencing the illustrations on the installation instruction. Please contact Blackjack if any parts are missing or damaged.
- This product is suitable for damp locations.

## INSTALLATION

### Preparation

1. Remove the fixture and all the parts from the box. Fixture parts included: one rear housing with integrated LED light source and one acrylic diffuser.
2. To remove the rear housing (11) from the diffuser(13) loosen the three side thumbscrews(10). (As shown in Fig.2)
3. Select the proper CCT color temperature by adjusting the CCT switch(1) on the back of the rear housing(11). (As shown in Fig.1)

### Electrical Connections

4. Using the wire connectors(9), connect the white supply wire(2) to the white fixture wire(3); connect the black supply wire(4) to the black fixture wire(5); and connect the house ground wire(6) to the fixture ground wire(7).
5. Carefully tuck all the wires back into the outlet box(8). (As shown in Fig.2).

### Mounting

6. Place the rear housing(11) over the outlet box(1). Carefully insert the body of the driver(14) into the junction box(8). Insert the mounting screws(12) through the slots on the rear housing(11). Then tighten them into the outlet box(8).
7. Align the holes on the side of the rear housing(11) with the holes on the side of the diffuser(13). Then insert and tighten the three thumbscrews(10) to secure them together.

### Dimming

8. Fixture requires a 120V input current and can dim with a TRIAC Dimmer. Can be upgraded to 120-277V driver with universal dimming (TRIAC, ELV, 0-10v dimmable)

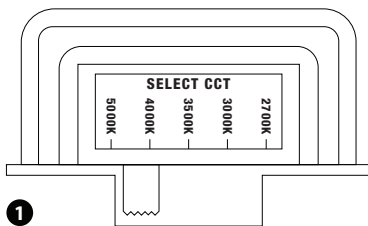
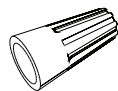

Figure 1

## HARDWARE



Wire Connector (#9)  
3 Included



Thumbscrews (#10)  
3 Included

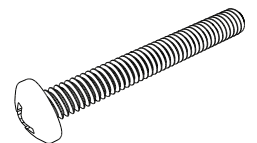

Mounting Screws (#12)  
2 Included

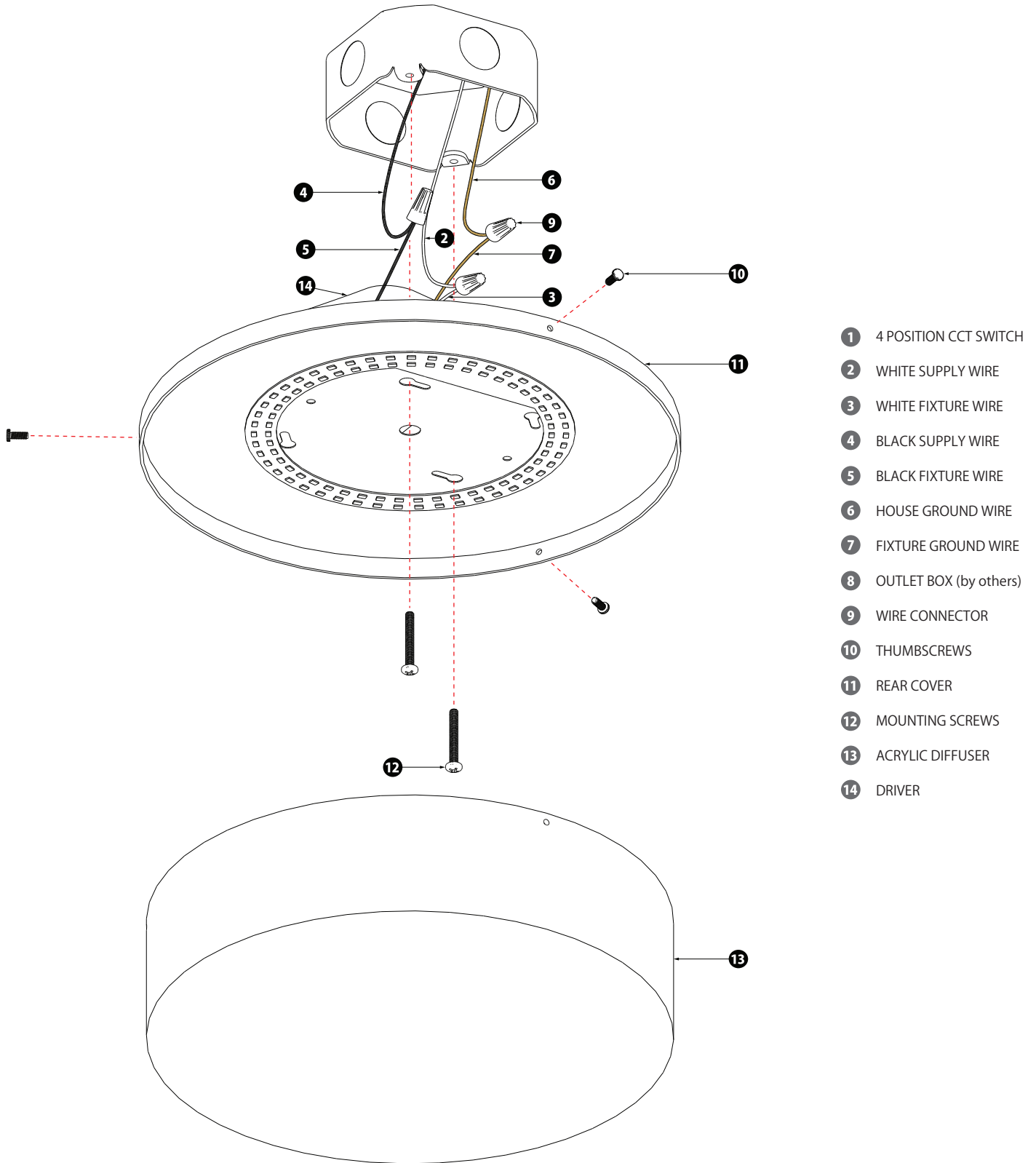

- 1 4 POSITION CCT SWITCH
- 2 WHITE SUPPLY WIRE
- 3 WHITE FIXTURE WIRE
- 4 BLACK SUPPLY WIRE
- 5 BLACK FIXTURE WIRE
- 6 HOUSE GROUND WIRE
- 7 FIXTURE GROUND WIRE
- 8 OUTLET BOX (by others)
- 9 WIRE CONNECTOR
- 10 THUMBSCREWS
- 11 REAR COVER
- 12 MOUNTING SCREWS
- 13 ACRYLIC DIFFUSER
- 14 DRIVER

Figure 2