

**STYLE No.** HNKM10<sup>†</sup>  
With Spray

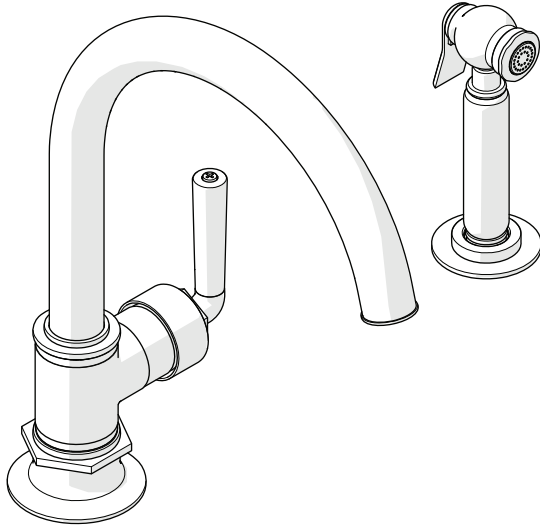

**STYLE No.** HNKM15<sup>†</sup>  
Without Spray

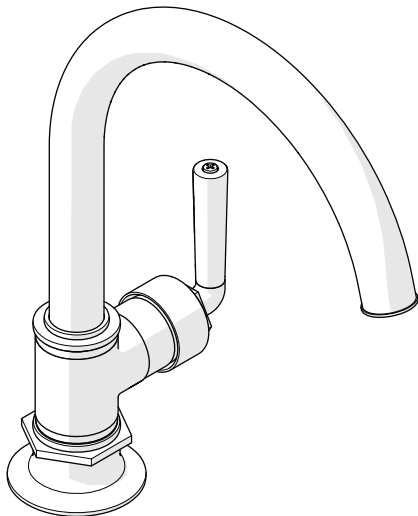

**SPECIFICATIONS:**

- Deck Thickness Maximum: 1-13/16" [46mm]
- Fitting Hole Diameter: 1-1/2" [38mm]
- Handle Turn Angle: Quarter Turn
- Hot Limit Stop: Yes
- Inlet Connection: 3/8" Compression Connector Hoses<sup>†</sup>
- Restricted Maximum Flow Rate: 2.2gpm [8.3L/min]
- Spray Hose Length (HNKM10 only): 49" [1.2m]
- Spout Reach: 9-5/8" [244mm]
- Spout Swivel: Yes
- Water Pressure Minimum: 20psi [1.5bar]
- Water Pressure Maximum: 85psi [6.0bar]
- Water Pressure Recommended: 45psi [3.0bar]

<sup>†</sup> UK Style No. **HN10KM** and **HN15KM** are supplied with 2 **BSP** adapters, assembly required.

**IMPORTANT:**

- To ensure this product is installed properly, you must read and follow these guidelines.
- The owner/user of this product must keep this information for future reference.
- This product must be installed by a professional licensed contractor.
- Ensure the installation conforms to all federal, state, and local codes. In the State of Massachusetts, all installations must comply with the rules and regulations set forth within 248 CMR.
- Inspect this product to ensure you have all the parts required for proper installation.
- Use only a strap wrench or protected/smooth-jaw wrench on any finished surface.
- **DO NOT** use putty on deck fittings.\* Upper and lower washers are provided.

**SPOUT INSTALLATION:**

- Refer to Figure - 01 for Steps 1 - 3.
- Note that the HNKM15, HN15KM will not have a spray hose, only hot and cold supply hoses.

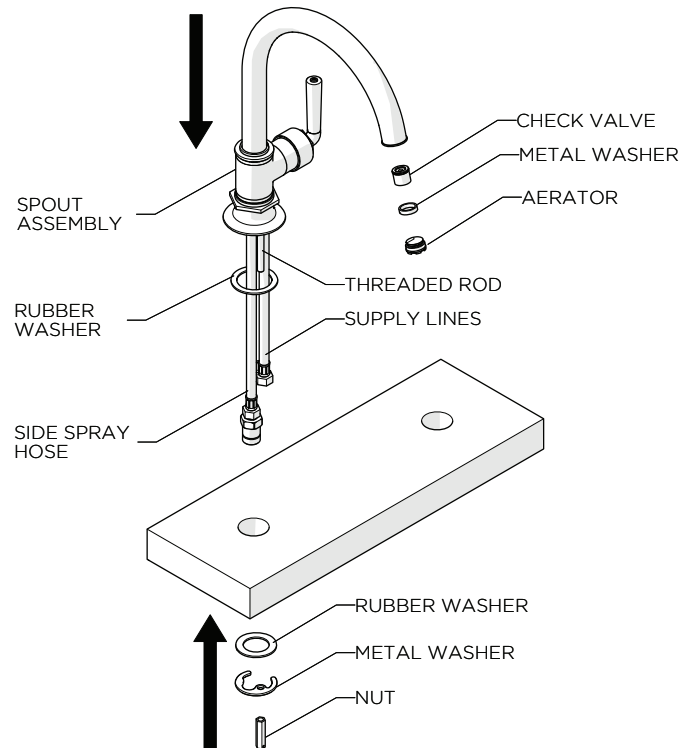

**FIGURE - 01**

1. Remove the black rubber washer, metal washer, and barrel nut from the threaded rod.

These guidelines have been prepared for the professional contractor to aid in the installation of: HENRY ONE HOLE GOOSENECK KITCHEN FAUCET WITH METAL LEVER HANDLE AND SPRAY (STYLE No. HNKM10, HN10KM) & HENRY ONE HOLE GOOSENECK KITCHEN FAUCET WITH METAL LEVER HANDLE (STYLE No. HNKM15, HN15KM). All dimensions are based on original specification and are subject to change and variation. Please consult your Design Associate for current specifications.

2. Ensure the hoses are securely tightened then insert the spout assembly through the mounting hole. Make sure the white rubber washer is in between the spout and the mounting surface.
3. Re-install the black rubber washer, metal washer and barrel nut to the threaded rod. Make sure to securely tighten the nut.

**SPRAY INSTALLATION:**

- See Figure - 02 for Steps 4 - 10.
- For installations without spray, proceed to Step 11.

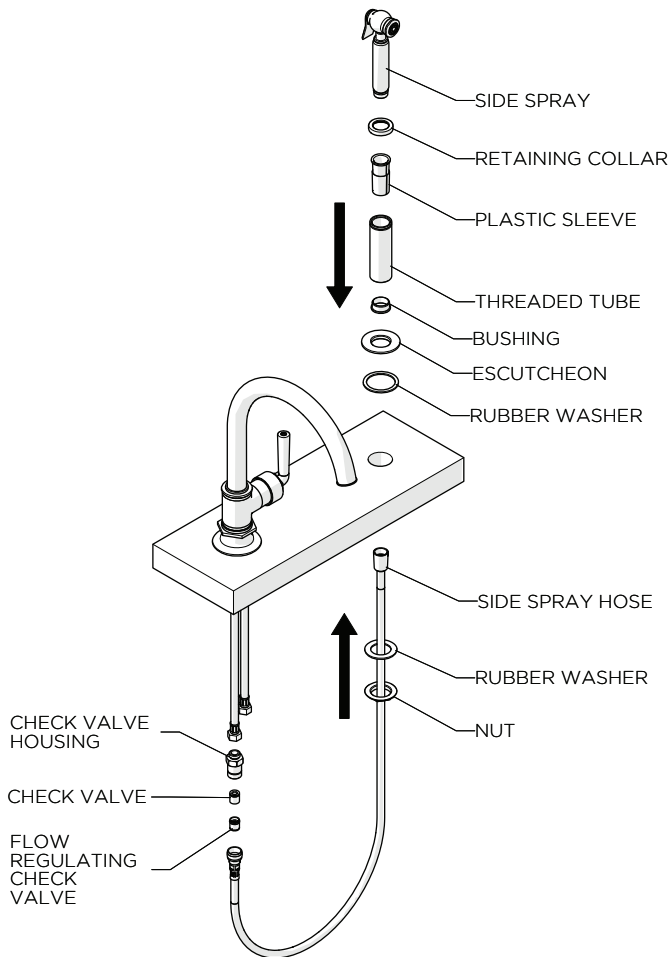
**FIGURE - 02**

4. Remove the nut, black rubber washer, retaining collar, and plastic sleeve from the threaded tube.
5. Insert the threaded tube along with the escutcheon into the mounting hole. Make sure the white rubber washer is between the escutcheon and mounting surface.
6. Re-install the black rubber washer and nut to the threaded tube. Do NOT tighten.

7. Slide the plastic sleeve and retaining collar over the conical end of the side spray hose then pass the knurled end of the hose through the threaded tube until the plastic sleeve is fully seated.
8. Thread the retaining collar back onto the threaded tube.
9. Ensure the escutcheon and retaining round collar contact each other then securely tighten the nut.
10. Connect the conical end of the hose to the side spray using the rubber washer provided then connect the knurled end of the hose to the check valve housing

**FINISH THE INSTALLATION:**

- See Figure - 01 for Steps 12 - 13.
- 11. Connect the hot and cold supply hoses to supply valves (Sold Separately). Ensure the hoses are securely tightened and are not pinched or kinked then open the valves.
- 12. Remove the aerator and metal washer using the tool provided. Slowly turn on the water to remove the check valve inside the spout.
- 13. Allow water to flow and fully flush out any debris in the supply lines.
- 14. Inspect all connections for leaks then re-install the check valve, metal washer, and aerator.

**NOTE:** 2-3 Seconds of residual water is typical on large gooseneck faucets.

- \* Putty contains oils and can cause permanent discoloration on certain materials such as marble, granite and any porous surface.
- If further assistance is required, please contact Product Support at 1-800-927-2120 Monday through Friday, 8am-6pm EST.
- Refer to the separate Service Parts Document for available replacement parts.
- The BSP adapters can be ordered separately:
  - Universal 9/16"-24 UNEF Male x 3/8" Female BSP Adapter  
**STYLE No. UNUK08**

These guidelines have been prepared for the professional contractor to aid in the installation of:  
HENRY ONE HOLE GOOSENECK KITCHEN FAUCET WITH METAL LEVER HANDLE AND SPRAY (STYLE No. HNKM10, HNK10KM) & HENRY ONE HOLE GOOSENECK KITCHEN FAUCET WITH METAL LEVER HANDLE (STYLE No. HNKM15, HNK15KM).  
All dimensions are based on original specification and are subject to change and variation.  
Please consult your Design Associate for current specifications.

WATERWORKS